

Approved  
*R. Fischer*  
 Surveyor General.  
 16 AUG 1944

SIDES.	ENGLISH FEET.	ANGLES OF DIRECTION.	SYSTEM L <sup>o</sup> 20 <sup>o</sup>	
			Y	X
		Constant	-160,000.0	+10800,000.0
AB	3308.4	268. 58. 10	A - 11823.1	+ 25392.3
BC	4628.8	331. 53. 50	B - 12130.5	+ 26331.0
CD	3321.8	348. 48. 10	C - 17344.3	+ 29475.8
DE	3630.8	58. 09. 40	D - 17588.4	+ 32734.5
EF	3858.1	114. 19. 30	E - 14303.9	+ 34649.9
FA	7680.6	183. 14. 40	F - 11388.3	+ 33060.6
DG	130.0	348. 48. 10	K - 10338.1	+ 25419.5
HE	284.0	114. 19. 30		
KA	1485.3	268. 58. 10		

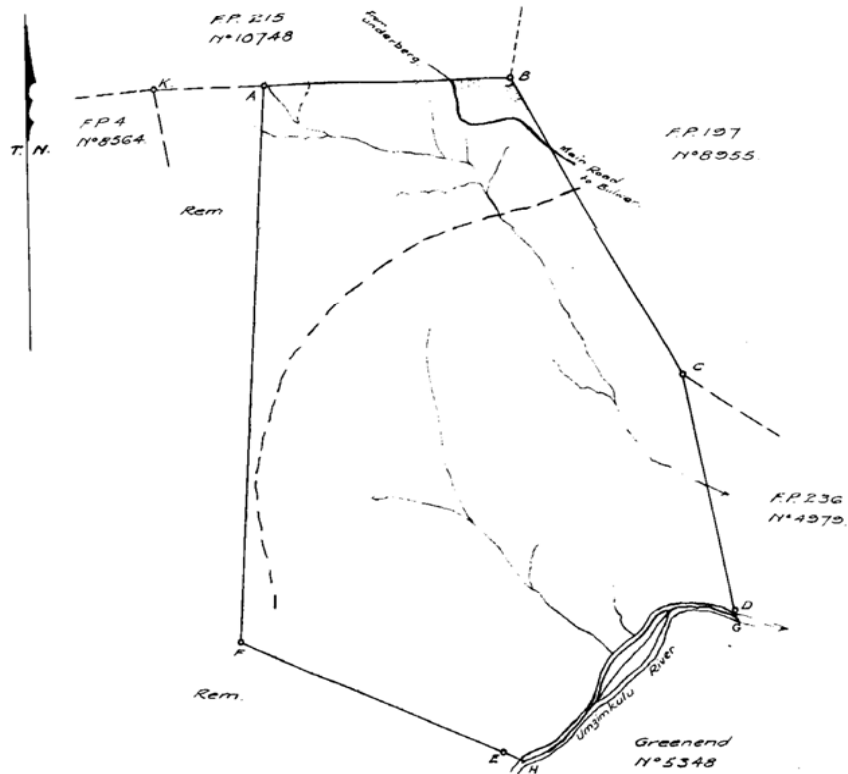

Description of Beacons.

- A - 1/2" iron peg under cairn. Witness marks 15' to B and F
- B - sneezewood post 4' high, at which three fences meet. Stones piled round post and witness marks 15' to A and C.
- C - sneezewood post 4' high, leaning over eastwards, at which four fences meet. Stones at base and witness marks 15' to B and D from centre of bottom of post
- D - sneezewood post, flat on one side and round on the other, 4.5' high at end of fence. Stones at base and witness mark 16' to C.
- E - 1/2" iron peg under cairn. Witness marks 15' to F and on F.E. produced
- F - 1/2" iron peg under cairn. Witness marks 15' to A and 14' to E.
- K - round sneezewood post 4.6' high at which two fences meet. Stones at base and witness mark 15' to A.

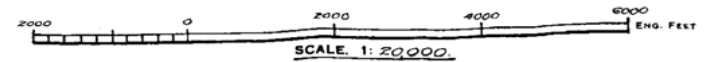

The figure A B C G middle of Umzimkulu River .H.F.

represents 1044.8765 Acres. of land being

Subdivision 1 of Lot F.P. 108 N°8563.

situate in the County of Pietermaritzburg Province of Natal.

Surveyed in April 1944, by me

Land Surveyor.

This diagram relates to <u>D.T.</u> No. <u>7528/1944</u> 26-10-44	The original diagram is <u>G.161</u> No. <u>264</u> Fol. <u>11</u> relating to Deed of Grant <i>(Sgt. T. Rautebach</i> No. <u>8563</u> Registrar of Deeds.	File No. <u>279</u> Survey Records <u>FS-BA.F555</u> Compilation <u>57</u> Degree Sheet <u>57</u> Tracing General Plan
---	--	---